



Smart Solutions ••• For Life

USER MANUAL



Issue August 2022 V2



Preface

Contact Details



TSG Associates LLP

Albany Works
Long Lover Lane
Pellon
Halifax
West Yorkshire
HX1 4QF
United Kingdom



Email info@tsgassociates.co.uk



Phone (UK) +44 (0) 1422 380097
Fax (UK) +44 (0) 1422 357639



Website www.tsgassociates.co.uk
Facebook www.facebook.com/TSGAssociates
LinkedIn www.linkedin.com/company/tsg-associates-llp



Index

	Page
Section One	
· Introduction	2
· Overview	3
· Specifications	5
· Options	15
Section Two - Xtract™SR Stretcher	
· Instructions	17
· Medical device information	18
· Pre-requisite for use	19
· Loading a casualty	20
· Dragging a casualty	21
· Lifting a casualty	22
· Xtract™SR Base	23
· Cleaning & inspection	24
Section Three - Xtract™SR Afloat	
· Instructions	27
· Pre-requisite for use	28
· Inflation of the Xtract™SR Afloat	30
· Moving a casualty	31
· Cleaning, inspection & storage	32
Section Four - Xtract™SR Heatsaver System	
· Instructions	34
· Pre-requisite for use	35
· Using the Xtract™SR Heatsaver system	36
· Cleaning & inspection	38

Section One: Introduction



CAUTION

This User Manual contains several safety warnings at the applicable points. Read and understand all the warnings before using the **Xtract™SR System**.

This User Manual reflects the state of the product at the issue date, but enhancements while in service may mean that the User Manual does not precisely reflect the **Xtract™SR System** that you have.

TSG Associates LLP reserves the right to make changes without notice both to this User Manual and the products which it describes.

No part of this publication may be reproduced, stored in a retrieval system or transmitted in any form or by any means, either electronically, mechanically, by photocopying, recording or otherwise, without the express prior written permission of the copyright holder.

Overview - Xtract™SR System



Obstacles to overcome:



Limited space
and weight



Rescuers'
fatigue



Continuing
care



Features
to cross



Making the
injury worse



Adverse
weather



WARNING

This User Manual contains general instructions on the use and maintenance of the product. The instructions do not cover all the possible applications and operations.

The safety information is provided as a service to the user and ensures only the minimum required level of safety to prevent injury to operators and casualties.

Any other safety measures implemented by the user must comply with applicable regulations, procedures and protocol. Before using the product, it is strongly recommended that staff be trained in its correct usage.

Retain this User Manual for future reference. In case of change of ownership, ensure that the User Manual remains with the product.

Additional copies can be obtained from TSG Associates LLP.

Overview - Xtract™SR System

The **Xtract™SR System** is a modular system that can be scaled to your mission requirements. Whatever the obstacles, the **Xtract™SR System** provides a solution.

Each module and component is designed to overcome obstacles. It's role in overcoming these is communicated by the icons below:-



Limited space and weight



Rescuers' fatigue



Continuing care



Features to cross



Making the injury worse



Adverse weather

The aim of the **Xtract™SR Stretcher** is to evacuate a casualty to a safe place whilst;

- ❖ Protecting against further injury.
- ❖ Maintaining care and treatment.
- ❖ Keeping the patient comfortable.
- ❖ Rescuers maintain optimal capabilities.
- ❖ Maximising core body temperature control.

Specification - Xtract™SR Stretcher

The **Xtract™SR Stretcher** is our smallest, lightest solution, ideal for foot patrol operations and buddy rescue.



Xtract™SR Stretcher

Part No - Refer to Options on Page 15

NSN 6530-99-315-5529

Class 1 Medical Device

UDI - 5060766500027

Achieved a classification of 'non-ignition' when tested to EN 597-1:2015 assessment of the ignitability of mattresses and upholstered bed bases: ignition source: smouldering cigarette

Intellectual Property Rights

Patents and design rights apply, for intellectual property please refer to our website www.tsgassociates.co.uk for details.

Obstacles to overcome:



Limited space and weight



Rescuers' fatigue



Continuing care



Features to cross



Making the injury worse

Details	Value Metric	Value Imperial
Maximum load	299 kg	660 lbs
Dimensions packed	280 x 180 x 120 mm	11 x 7 x 5 in
Dimensions deployed	2690 x 1030 mm	106 x 41 in
Weight	960 g	34 oz
Colour	Black	Black
Sterile	No	No



Specification - Xtract™SR Base

The **Xtract™SR Base** is a detachable insulated component, designed to help protect a casualty from environmental conditions and improve their comfort. It can come fitted to your **Xtract™SR Stretcher** or supplied as a stand-alone individual component.



Obstacles to overcome:



Rescuers' fatigue



Continuing care

Xtract™SR Base

Part No 72110

NSN 5340-99-155-7863

Achieved a classification of 'non-ignition' when tested to EN 597-1:2015.

Intellectual Property Rights

Patents and design rights apply, for intellectual property please refer to our website www.tsgassociates.co.uk for details.

Details	Value Metric	Value Imperial
Dimensions packed	540 x 120 x 120 mm	21 x 5 x 5 in
Dimensions deployed	2210 x 540 mm	87 x 21 in
Weight	1340 g	47 oz
Colour	Black	Black
Sterile	No	No



Specification - Xtract™SR Backpack

The **Xtract™SR Backpack** provides a practical rugged solution to carrying your **Xtract™SR Stretcher**. It can accommodate one **Xtract™SR Stretcher** with base attached or five **Xtract™SR fabric stretchers**.

Xtract™SR Backpack
Part No 72109



Obstacles to overcome:



Limited space
and weight



Rescuers'
fatigue



Features
to cross

Details	Value Metric	Value Imperial
Maximum load	35 kg	77 lbs
Dimensions deployed	600 x 260 mm	24 x 10 in
Weight	760 g	27 oz
Colour	Black	Black
Sterile	No	No



Specification - Xtract™SR Equaliser

The **Xtract™SR Equaliser** is a solution carrying an **Xtract™SR Stretcher** and equipment. Easy access pouches with the ability to adapt configuration makes this the ideal solution for medical personnel working in austere environments.



Xtract™SR Equaliser

Part No 72166

Obstacles to overcome:



Limited space and weight



Rescuers' fatigue



Continuing care



Features to cross

Details	Value Metric	Value Imperial
Maximum load	35 kg	77 lbs
Dimensions deployed	Pouch 420.5 x 150 x 115 mm Backpack 600 x 260 mm	17 x 6 x 5 in 27 x 10 in
Total weight	920 g	32 oz
Colour	Black	Black
Sterile	No	No



Specification - Xtract™SR XStraps

The **Xtract™SR XStraps** are a utility tool designed to assist an evacuation and use of the **Xtract™SR Stretcher**.



Xtract™SR XStraps

Part No 72105

NSN 5340-99-925-1991

Achieved a classification of 'non-ignition' when tested to EN 597-1:2015 assessment.

Obstacles to overcome:



EN 12275:2013 B - Mountaineering equipment - Connectors - Safety requirements and test methods. UIAA121:2009 – Connectors and Karabiners.

Intellectual Property Rights
Patents and design rights apply,
for intellectual property
please refer to our website
www.tsgassociates.co.uk
for details.

Details	Value Metric	Value Imperial
Maximum load (per strap)	200 kg	441 lbs
Dimensions packed	130 x 70 x 36 mm	5 x 3 x 1 in
Dimensions deployed	2660 x 360 mm	105 x 14 in
Weight	300 g	11 oz
Colour	Black / Red Carabiners	Black / Red Carabiners
Sterile	No	No



Specification - Xtract™SR Afloat

The **Xtract™SR Afloat** is a compact casualty flotation product for rescuers. Only for use on water that is unobstructed, flat and non-technical. **Xtract™SR Afloat** can also be used as an insulating mattress to improve patient comfort.



Obstacles to overcome:



Limited space
and weight



Features
to cross

Xtract™SR Afloat

Part No Xtract™SR Afloat
(72131)

Class 1 medical device
accessory

Unique device identification
5060766500034

Intellectual Property Rights
Patents and design rights apply,
for intellectual property
please refer to our website
www.tsgassociates.co.uk for details.

Details	Value Metric	Value Imperial
Maximum load	127 kg	280 lbs
Dimensions packed	320 x 160 x 140 mm	13 x 6 x 6 in
Dimensions not inflated	2510 x 1010 mm	99 x 40 in
Dimensions inflated	2275 x 830 mm	90 x 33 in
Weight	134 g	5 oz
Colour	Black	Black
Operating temperature	-18°C to 50°C	0.39°F to 122°F
Buoyancy	350 n	350 n
Sterile	No	No



Specification - Xtract™SR Heatseal

The **Xtract™SR Heatseal** provides targeted insulation. Its minimal size and weight focuses insulating fibres targeted at the body's core to maximise effect.



Xtract™SR Heatseal & Deployer

Part No 72136

Xtract™SR Heatsaver System

Part No 72137

Obstacles to overcome:



Limited space
and weight



Continuing
care



Adverse
weather

Intellectual Property Rights
Patents and design rights apply,
for intellectual property
please refer to our website
www.tsgassociates.co.uk for details.

Details	Value Metric	Value Imperial
Dimensions packed	Packed in Deployer	Packed in Deployer
Dimensions deployed	2150 x 870 mm	85 x 34 in
Weight	820 g	29 oz
Colour	Black	Black
Sterile	No	No



Specification - Xtract™SR Insulate

The **Xtract™SR Insulate** provides insulation from conduction heat loss to the ground.



Xtract™SR Insulate
Part No 72114

Obstacles to overcome:



Limited space
and weight



Continuing
care



Adverse
weather

Intellectual Property Rights
Patents and design rights apply,
for intellectual property
please refer to our website
www.tsgassociates.co.uk for details.

Details	Value Metric	Value Imperial
Dimensions packed	280 x 120 x 8 mm	11 x 5 x 0.3 in
Dimensions not inflated	2446 x 606 mm	96 x 24 in
Dimensions inflated	2170 x 540 x 200 mm	85 x 21 x 8 in
Weight	640 g	23 oz
Colour	Black	Black
Operating temperature	-18°C to 50°C	0.39°F to 122°F
Sterile	No	No



Specification - Xtract™SR EPS

The **Xtract™SR EPS** protects from the environment by providing a cover that is resistant to rain and wind.

Xtract™SR EPS

Part No 72116



Obstacles to overcome:



Continuing care



Adverse weather

Intellectual Property Rights
Patents and design rights apply,
for intellectual property
please refer to our website
www.tsgassociates.co.uk for details.

Details	Value Metric	Value Imperial
Dimensions packed	320 x 120 mm	13 x 5 in
Dimensions deployed	1760 x 1050 mm	69 x 41 in
Weight	340 g	12 oz
Colour	Green	Green
Sterile	No	No



Specification - Xtract™SR Deployer

The **Xtract™SR Deployer** is designed to hold all components of our **Xtract™SR Heatsaver System** in an organised, secure and compact configuration.



Obstacles to overcome:

Xtract™SR Heatseal and Deployer

Part No 72136

Xtract™SR Heatsaver System

Part No 72137



Limited space
and weight



Adverse
weather

Intellectual Property Rights
Patents and design rights apply,
for intellectual property
please refer to our website
www.tsgassociates.co.uk for details.

Details	Value Metric	Value Imperial
Dimensions packed	420 x 200 x 200 mm	17 x 8 x 8 in
Dimensions deployed	910 x 420 mm	36 x 17 in
Weight unpacked	520 g	18 oz
Colour	Black	Black
Sterile	No	No



Options - Xtract™SR

The **Xtract™SR System** provides the rescuer and organisation with a unique blend of modular options that can be configured depending on operational parameters.

Xtract™SR Stretcher – Part No 72111



Xtract™SR Module – Part No 72120



Options - Xtract™SR

Xtract™SR Complete – Part No 72121

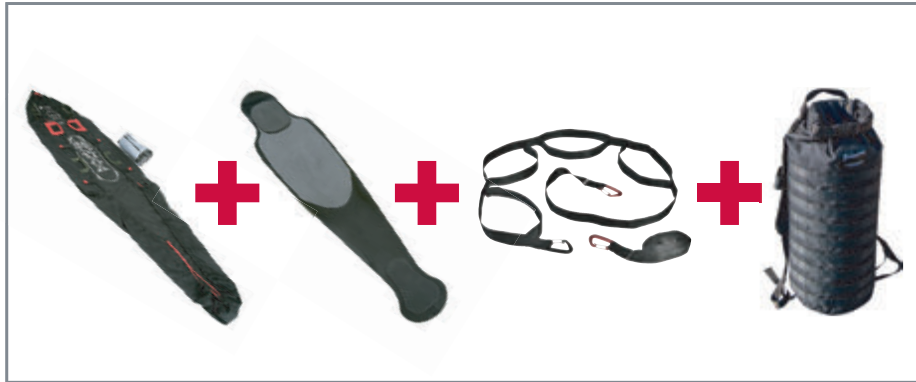

Xtract™SR Heatsaver System – Part No 72137



Section Two: Xtract™SR Stretcher - Instructions

A modular system that can be scaled to your mission requirements.



Obstacles to overcome:



Limited space and weight



Rescuers' fatigue



Continuing care



Features to cross



Adverse weather



WARNING

It is the responsibility of the user of lifting, rescue and safety equipment to obtain competent training, instruction and take adequate precautions for safety when using the equipment.

The use of the Xtract™SR Stretcher presumes that medical support is limited and the user has determined that the Xtract™SR Stretcher is the best method to move the casualty.

Suitability of the Xtract™SR Stretcher will vary according to the situation. There is no guarantee of the product's effectiveness in your specific working situation.

Medical device information



WARNING - Risk of product failure

Only use the **Xtract™SR Stretcher** for the purposes described in this User Manual. Do not use the **Xtract™SR Stretcher** for any other purposes.

TSG Associates LLP declares that both the **Xtract™SR Stretcher** and **Xtract™SR Afloat** comply with the UK Medical Devices Regulations 2002 (SI 2002 No 618 as amended) which were amended by the Medical Devices (Amendments etc.) (EU Exit) Regulations 2019 and the Medical Devices (Amendments etc.) (EU Exit) Regulations 2020.

TSG Associates LLP declares under its sole responsibility that the **Xtract™SR Stretcher** and **Xtract™SR Afloat** is in conformity with the applicable requirements of (EU) 2017/745 of the European Parliament and of the Council of 5 April 2017 concerning Medical Devices.

The EU Medical Device Directive - annex I, items 1 and 2, has been adhered to, in that:

The device has been designed and manufactured in such a way that, when used under the conditions and for the purposes intended, users will not compromise the clinical condition or the safety of the casualty, or the safety and health of users or other persons.

Solutions and mitigations to identified risks have been adopted by first seeking to eliminate or reduce the risk as far as possible, followed by adding protective measures. Finally by informing users of any residual risks due to any shortcomings of the adopted protective measures.

Pre-requisites for use



WARNING - Risk of product failure

Prior to use the following checks must be completed to ensure safe functioning of the equipment.

A grey box indicates where a check is required for a particular piece of equipment.

Checks required prior to use	Xtract™SR Stretcher	Xtract™SR XStraps	Xtract™SR Base	Xtract™SR Backpack
Are you competent to use the equipment?	Grey	Grey	Grey	Grey
Is the equipment appropriate for the casualty's condition?	Grey	Grey	Grey	Grey
Is the task within the equipment's capacity?	Grey	Grey	Grey	Grey
Material in good condition?	Grey	Grey	Grey	Grey
Stitching free from defect?	Grey	Grey	Grey	Grey
Clean and free from soiling?	Grey	Grey	Grey	Grey
Components required	Xtract™SR Stretcher	Xtract™SR XStraps	Xtract™SR Base	Xtract™SR Backpack
Manual	Grey	Grey	Grey	Grey
Zip ties	Black	Black	Grey	Black

Loading a casualty into the Xtract™SR Stretcher



WARNING - Risk of injury

It is the rescuer's responsibility to assess the suitability of the Xtract™SR Stretcher for the evacuation of the casualty.

Place the Xtract™SR Stretcher adjacent to the casualty.

The casualty's shoulders should be aligned to the red shoulder handles.

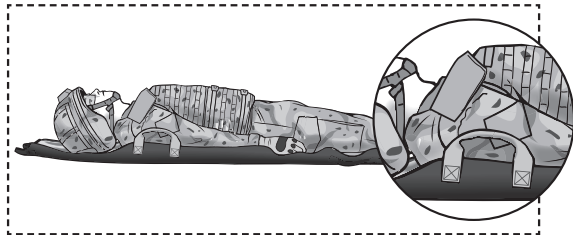

Position under the casualty.

Use the drawstring at the foot and head end to tighten the Xtract™SR Stretcher around the casualty until it fits securely.

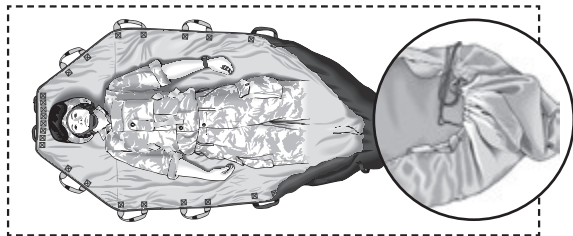

Secure the Xtract™SR Stretcher by use of the "fast strap" bungees. Pass them across the casualty and secure firmly with velcro.

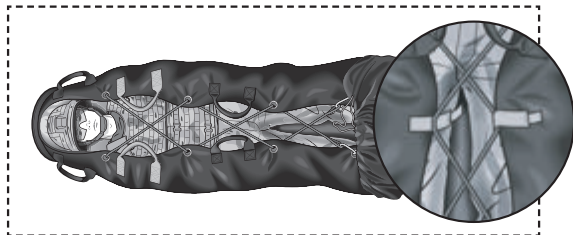

Dragging a casualty with the Xtract™SR Stretcher & Xtract™SR XStraps



WARNING - Risk of serious injury

Dragging from shoulder handles should only be used with the Xtract™SR Base fitted correctly. There is a risk of serious head injury if this is not in place.

Load the casualty into the Xtract™SR Stretcher with a base attached.

Before using the Xtract™SR XStraps, complete the pre-requisites for use checks.

Clip a carabiner into the red shoulder handle towing loop.

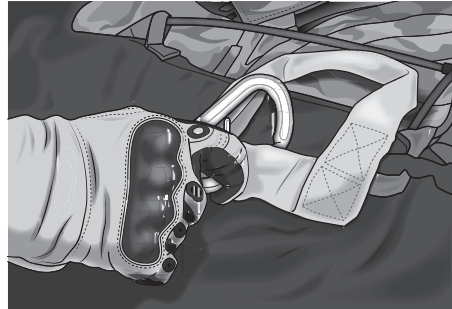

Unroll the Xtract™SR XStraps and use to assist a drag extraction.



Lifting a casualty in the Xtract™SR Stretcher using the Xtract™SR XStraps

Load the casualty into the **Xtract™SR Stretcher**.

Before using the **Xtract™SR XStraps**, complete the pre-requisites for use.

Clip the carabiner into the red shoulder handle.

Select a loop on your **Xtract™SR XStrap** and place a carabiner through it.

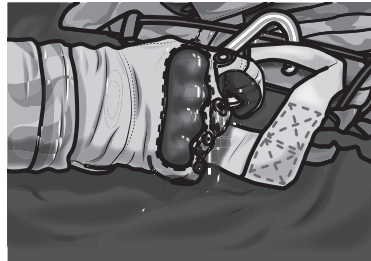

Clip the carabiner into the green pelvis handle, this will create a loop in the webbing.

Pass the webbing strap over your shoulder.



As a team, slowly lift the casualty keeping your hands on the pelvis handles.

Additional rescuers may be required to assist the lift and align the casualty's position.



Xtract™SR Base – How to attach it to the Xtract™SR Stretcher



WARNING

Be careful not to cut any fabric when replacing the old Xtract™SR Base as this will result in the Xtract™SR Stretcher being rendered unusable.

The Xtract™SR Base is designed to be a replaceable component.

Before using the Xtract™SR Base, complete the pre-requisites for use.

Suitability for use remains solely with the rescuer.

Remove the old Xtract™SR Base by cutting the zip ties (be careful not to cut any fabric as this will result in the Xtract™SR Stretcher being rendered unusable).

Open your Xtract™SR Stretcher with the molle loop attachments facing upwards.

Align the new Xtract™SR Base with the molle loop.

Start by inserting and tightening with the zip ties first at the foot then the head end of the Xtract™SR Stretcher.

Complete the assembly by inserting the zip ties through every hole in the plastic base, ensuring that they are as tight as you can get them.

When completed check the assembly is secure.

NOTES

For best results zip ties should be inserted up through the molle loop first and then through the plastic base holes.

Excess zip tie plastic can be tucked between the base and plastic.

We do not recommend you cut the zip ties.



Xtract™SR Stretcher - Cleaning



WARNING - Damage to product

DO NOT use bleach, industrial detergent, acids, oxidising agents, alkaline, caustic substances or boiling water on any Xtract™SR Stretcher products.

Xtract™SR Stretcher

General cleaning;

Wash not exceeding 40°C by hand with pure soap and rinse in clean cold water.

Disinfecting;

Machine wash at 60°C with a mild domestic detergent (maximum of five times).

Xtract™SR Base

General cleaning;

Remove the **Xtract™SR Base** before general cleaning. Wash by hand, using warm water with a mild domestic detergent and single use cloth.

Disinfecting;

Remove from the **Xtract™SR Base** before disinfecting. If any of the absorbent surfaces are biologically contaminated it should be discarded and disposed of in a suitable manner.

Xtract™SR XStraps

General cleaning;

Wash and clean by hand, not exceeding 30°C, with pure soap and rinse in clean cold water.

Disinfecting;

If the product is biologically contaminated it should be discarded and disposed of in a suitable manner.

Xtract™SR Stretcher - Inspection



WARNING - Risk of product failure

Pre-use and thorough inspections are essential.

The user's and casualty's safety depends on the continuing correct performance of the products.

Inspection

Equipment must be checked before and after each use to ensure it is serviceable and operates correctly.

Additionally, a thorough inspection should be carried out every six months by a competent person. A record of these checks should be kept.

Interim detailed inspections should be carried out where products are used intensively, or in particularly harsh environments.

Storage

All equipment must be clean and dry before storing.

Always allow to dry naturally away from direct heat.

Storage should be in a cool, dry, well-ventilated area away from excessive heat, humidity, sharp edges, corrosives, sunlight and other sources of UV light.

Xtract™SR Stretcher - Inspection

Product code	Product name	Batch number / UDI number	Purchase date	
Record of inspection				
Date	Comments	Name Initials	Next due	
Disinfection				
	Signature	Date		
1				
2				
3				
4				
5				

Section Three: Xtract™SR Afloat - Instructions

The **Xtract™SR Afloat** is a compact casualty flotation product.



Obstacles to overcome:



Limited space
and weight



Features
to cross



WARNING

Safe water operations require specialised skills, training and practise which are outside the scope of this User Manual. The **Xtract™SR Afloat** is not a personal flotation device.

A pre-requisite for safe operation of the **Xtract™SR Afloat** is that the users have been trained to a competent standard in water operations techniques and methods.

The following instructions have been written on the assumption that the users are trained and competent in water operations.

Pre-requisites for use



WARNING

Only for use on water that is unobstructed, flat and non-technical.

Before using the product, read and understand the product User Manual and instructions on the outer bag. Suitability of the Xtract™SR Afloat will vary according to the situation.

There is no guarantee of the product's effectiveness in your specific working situation.

The Xtract™SR Afloat can only be used in conjunction with the Xtract™SR and Xtract™2 Stretchers.

Always do your own risk assessment.

Pre-requisites for use



WARNING - Risk of product failure

Prior to use the following checks must be completed to ensure safe functioning of the equipment.

A grey box indicates where a check is required for a particular piece of equipment.

Checks required prior to use	Xtract™SR Afloat
Are you competent to use the equipment?	
Read the safety and operational instructions which can be found in the User Manual, outer bag and the left and right-hand buoyancy chambers of the Xtract™SR Afloat.	
Is the equipment appropriate for the casualty's condition?	
Is the task within the equipment's capacity? Water to be crossed must be unobstructed, flat and non-technical.	
Material in good condition and no punctures?	
Welds free from defect?	
Clean and free from soiling?	
3 Inflation valves have caps?	
11 Bungee toggles present?	
Bungee toggles elastic in good condition with plastic globe attached?	
One bungee toggle inserted into each grommet hole on the Xtract™SR Afloat?	
Components required	
Manual	
11 Bungee toggles	
External packaging bag	
Xtract™SR Afloat	

Inflation of the Xtract™SR Afloat

The three buoyancy chambers can be inflated in any order.

Unscrew the top of one of the inflation valves.

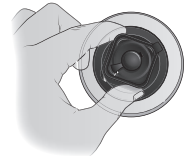

Inflate the associated buoyancy chamber by blowing into the one-way valve until the buoyancy chamber is fully inflated.



Refit the top of the inflation valve. Ensure the top of the inflation valve is screwed fully home.

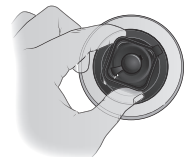

Repeat the previous three steps for the remaining two inflation valves.

NOTE - Check that there are no leaks from any of the three buoyancy chambers.



Moving a casualty onto the Xtract™SR Afloat

The casualty **MUST** be in an **Xtract™SR Stretcher** in order to use the **Xtract™SR Afloat**. There must be at least one person at the head of the **Xtract™SR Afloat** at all times when a patient is placed in the device - whether on dry ground or in the water.

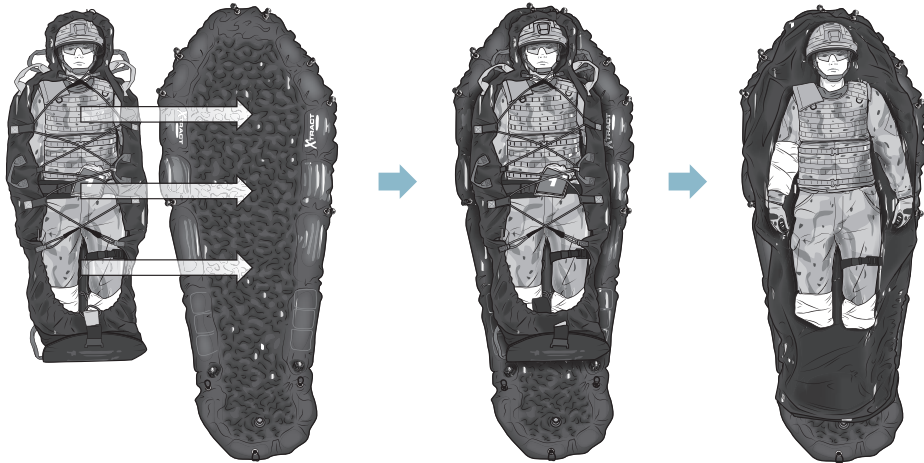

(1) Place the casualty held within an **Xtract™SR Stretcher** onto the **Xtract™SR Afloat**. Make sure the orientation is correct with the casualty's head at the head end of the **Xtract™SR Afloat**.

(2) Release all the straps that secure the casualty in the **Xtract™SR Stretcher**.

(3) Secure the **Xtract™SR Stretcher** to the **Xtract™SR Afloat** using the 11 attaching toggles.

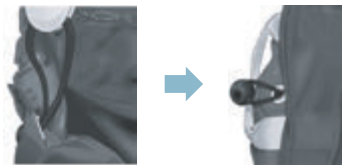

WARNING - Danger of drowning

Before placing onto water check that the casualty has been placed on the **Xtract™SR Afloat** correctly and is free from all straps and restraints.

Xtract™SR Afloat – Cleaning, inspection & storage



WARNING - Damage to product

DO NOT use bleach, industrial detergent, acids, oxidising agents, alkaline, caustic substances or boiling water on any Xtract™SR products.

General cleaning;

Hand wash using warm water with a mild domestic detergent and a single use cloth.

Rinse the **Xtract™SR Afloat** with a mixture of clean water and a mild domestic disinfectant. Rinse the **Xtract™SR Afloat** again with clean water.

Dry the **Xtract™SR Afloat** with a towel and allow it to air dry.

Disinfecting;

Use a tuberculocidal disinfectant, following the manufacturer's instructions. Rinse and dry as noted in "general cleaning".

Inspection;

Equipment must be checked before and after each use to ensure it is serviceable and operates correctly.

Additionally, a thorough inspection should be carried out every six months by a competent person. A record of these checks should be kept.

Interim detailed inspections should be carried out where products are used intensively, or in particularly harsh environments.

Storage;

All equipment must be clean and dry before storing.

Always allow to dry naturally away from direct heat.

Storage should be in a cool, dry, well-ventilated area away from excessive heat, humidity, sharp edges, corrosives, sunlight and other sources of UV light.

Xtract™SR Afloat - Inspection

Product code	Product name	Batch number / UDI number	Purchase date	
Record of inspection				
Date	Comments	Name Initials	Next due	

Section Four: Xtract™SR Heatsaver System - Instructions

The Xtract™SR Heatsaver System is a passive insulating solution.



Obstacles to overcome:



Limited space
and weight



Continuing
care



Adverse
weather



WARNING

It is the responsibility of the user of the equipment to obtain competent training, instruction and take adequate precautions for safety when using the equipment.

Suitability for use will vary according to the situation. There is no guarantee of the product's effectiveness in your specific working situation.

Pre-requisites for use



WARNING - Risk of product failure

Prior to use the following checks must be completed to ensure safe functioning of the equipment.

A grey box indicates where a check is required for a particular piece of equipment.

Checks required prior to use	Xtract™SR Deployer	Xtract™SR Insulate	Xtract™SR Heatseal	Xtract™SR EPS
Are you competent to use the equipment?	Grey	Grey	Grey	Grey
Is the equipment appropriate for the casualty's condition?	Grey	Grey	Grey	Grey
Is the task within the equipment's capacity?	Grey	Grey	Grey	Grey
Material in good condition?	Grey	Grey	Grey	Grey
Stitching free from defect?	Grey	Grey	Grey	Grey
Clean and free from soiling?	Grey	Grey	Grey	Grey
Components required	Xtract™SR Deployer	Xtract™SR Insulate	Xtract™SR Heatseal	Xtract™SR EPS
Manual	Grey	Grey	Grey	Grey
2 tent pegs	Grey	Black	Black	Black

Using the Xtract™SR Heatsaver System

Unclip the three buckles on the **Xtract™SR Deployer**.

If required, secure the **Xtract™SR Deployer** into the ground using the two grommet holes and tent pegs.



Unscrew the top of the inflation valve, located at the bottom of the **Xtract™SR Insulate**.

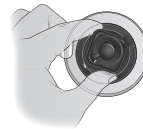

Inflate **Xtract™SR Insulate** by blowing into the one-way valve until the chamber is fully inflated.



Refit the top of the inflation valve. Ensure the top of the inflation valve is screwed fully home.

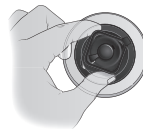

Place the **Xtract™SR Insulate** into the **Xtract™SR Stretcher**.



Using the Xtract™SR Heatsaver System



WARNING - Risk of injury

It is the responsibility of the trained operator to assess how much insulation is required depending on the climate they are working in. Additional insulation to the Xtract™SR Heatseal may be required.

Place the **Xtract™SR Heatseal** over the casualty.

Place the head wrap around the head and secure.

Additional insulation may be required depending on the environment you are working in.

Secure the **Xtract™SR Stretcher** around the **Xtract™SR Heatseal**.

Place the **Xtract™SR EPS** over the casualty's head ensuring the face is not covered.

Pull the **Xtract™SR EPS** down and secure around the feet.

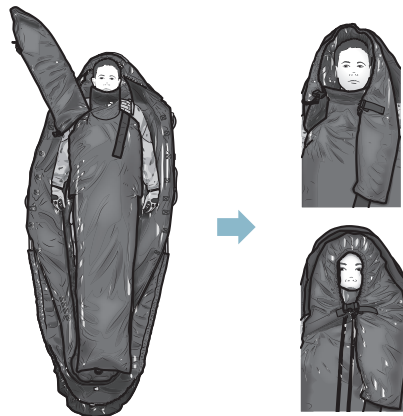

Xtract™SR Heatsaver System - Cleaning



WARNING - Damage to product

DO NOT use bleach, industrial detergent, acids, oxidising agents, alkaline, caustic substances or boiling water on any Xtract™SR products.

Xtract™SR Insulate

General cleaning;

Hand wash using warm water with a mild domestic detergent and a single use cloth.

Rinse the **Xtract™SR Insulate** with a mixture of clean water and a mild domestic disinfectant. Rinse the **Xtract™SR Insulate** again with clean water.

Dry the **Xtract™SR Insulate** with a towel or allow it to air dry.

Disinfecting;

Use a tuberculocidal disinfectant, following the instructions. Rinse and dry as noted in "general cleaning".

Xtract™SR Heatseal

General cleaning;

Machine wash, not exceeding 30°C, with pure soap and rinse in clean cold water. Allow to air dry.

Disinfecting;

Machine wash at 60°C using a standard domestic detergent and allow it to air dry (maximum of 5 times).

Xtract™SR EPS

General cleaning;

Hand wash, not exceeding 30°C, with pure soap and rinse in clean cold water.

Disinfecting;

If the product is biologically contaminated it should be discarded and disposed of in a suitable manner.

Xtract™SR Heatsaver System - Inspection



WARNING - Risk of product failure

Pre-use and thorough inspections are essential.

The user's and casualty's safety depends on the continuing correct performance of the products.

Inspection

Equipment must be checked before and after each use to ensure it is serviceable and operates correctly.

Additionally, a thorough inspection should be carried out every six months by a competent person. A record of these checks should be kept.

Interim detailed inspections should be carried out where products are used intensively, or in particularly harsh environments.

Storage

All equipment must be clean and dry before storing.

Always allow to dry naturally away from direct heat.

Storage should be in a cool, dry, well-ventilated area away from excessive heat, humidity, sharp edges, corrosives, sunlight and other sources of UV light.

We recommend that the **Xtract™SR Heatseal** is not stored compressed.

Xtract™ SR Heatsaver System - Inspection

Product code		Product name		Purchase date	
Record of inspection					
Date	Comments			Name Initials	Next due

Notes



TSG Associates LLP
Albany Works
Long Lover Lane, Pellon
Halifax, HX1 4QF
United Kingdom

T : +44 (0)1422 380097
F : +44 (0)1422 357639

www.tsgassociates.co.uk

